

- >When assembling engine, lightly grease **o-rings** and **threads**
- >Underline parts are your reusable 24/40 parts.
- >All diagrams have the same Aft to Forward perspective.

**Delay Assembly**

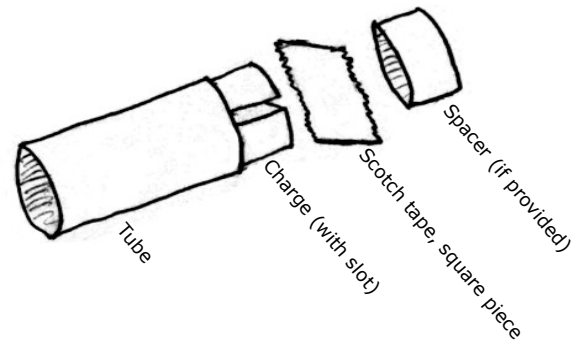
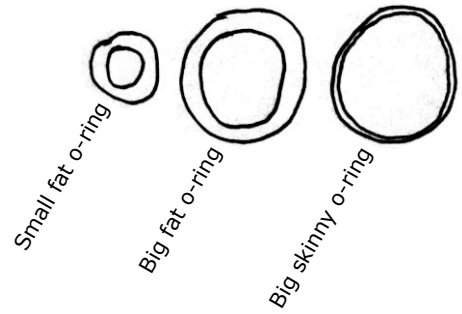
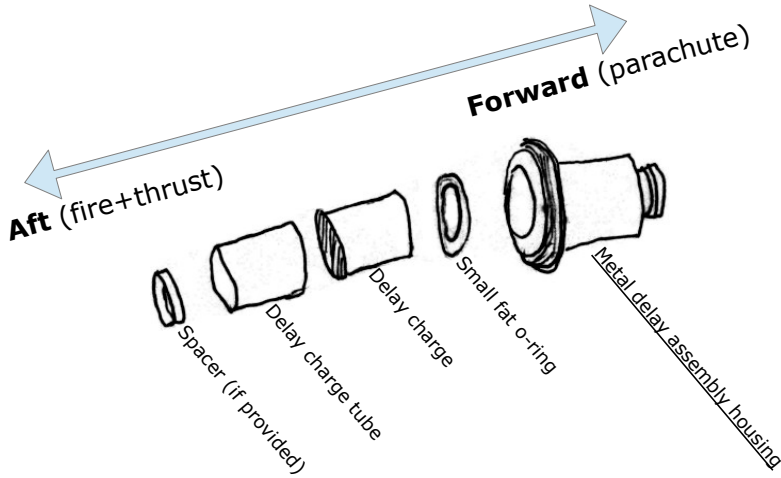

**Main charge assembly**

Push the Tube, Charge, Scotch tape, and Spacer together until flush with Aft end. Once the engine is together, the Scotch tape will act as a stop to properly position the igniter.

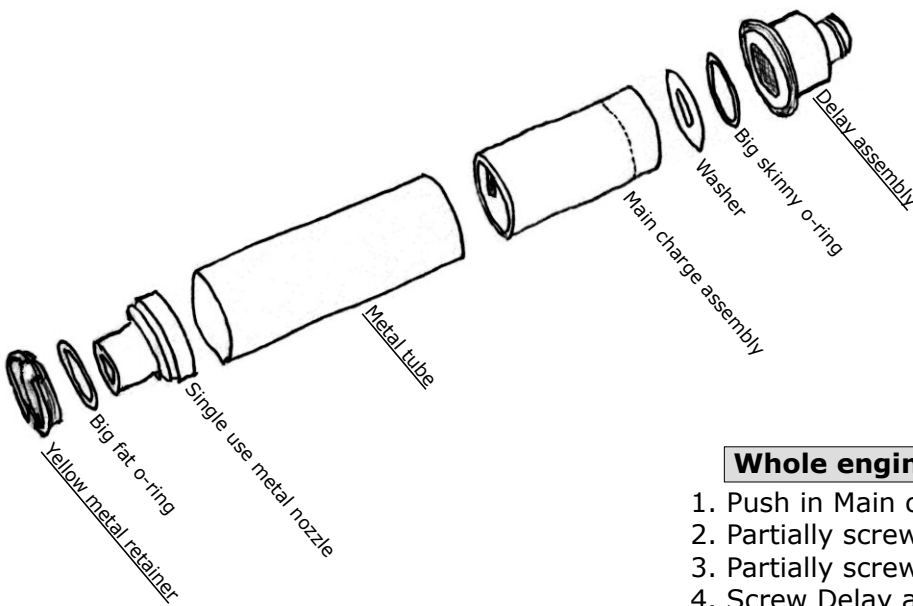

**Whole engine assembly**

1. Push in Main charge assembly and center in Metal tube
2. Partially screw in Delay assembly
3. Partially screw in Yellow metal retainer
4. Screw Delay assembly all the way in
5. Screw Yellow metal retainer all the way in.